

Position switches FM series

- Contact type:
- R** = snap action
 - L** = slow action
 - LO** = slow action overlapped
 - LS** = slow action shifted
 - LV** = slow action shifted and spaced
 - LI** = slow action independent
 - LA** = slow action closer
 - E1** = electronic PNP

Contact blocks

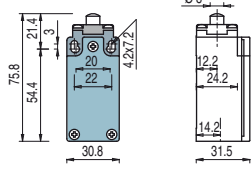

With stainless steel roller on request

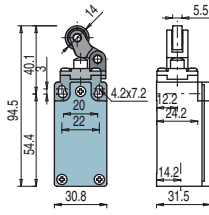

With external rubber gasket

With stainless steel roller on request

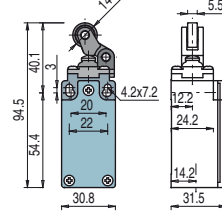

With external rubber gasket

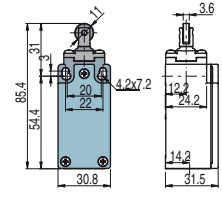

5	R	FM 501-M2	1NO+1NC	FM 502-M2	1NO+1NC	FM 5A2-M2	1NO+1NC	FM 5A4-M2	1NO+1NC
6	L	FM 601-M2	1NO+1NC	FM 602-M2	1NO+1NC	FM 6A2-M2	1NO+1NC	FM 6A4-M2	1NO+1NC
7	LO	FM 701-M2	1NO+1NC	FM 702-M2	1NO+1NC	FM 7A2-M2	1NO+1NC	FM 7A4-M2	1NO+1NC
9	L	FM 901-M2	2NC	FM 902-M2	2NC	FM 9A2-M2	2NC	FM 9A4-M2	2NC
10	L	FM 1001-M2	2NO	FM 1002-M2	2NO	FM 10A2-M2	2NO	FM 10A4-M2	2NO
11	R	FM 1101-M2	2NC	FM 1102-M2	2NC	FM 11A2-M2	2NC	FM 11A4-M2	2NC
12	R	FM 1201-M2	2NO	FM 1202-M2	2NO	FM 12A2-M2	2NO	FM 12A4-M2	2NO
13	LV	FM 1301-M2	2NC	FM 1302-M2	2NC	FM 13A2-M2	2NC	FM 13A4-M2	2NC
14	LS	FM 1401-M2	2NC	FM 1402-M2	2NC	FM 14A2-M2	2NC	FM 14A4-M2	2NC
15	LS	FM 1501-M2	2NO	FM 1502-M2	2NO	FM 15A2-M2	2NO	FM 15A4-M2	2NO
18	LA	FM 1801-M2	1NO+1NC	FM 1802-M2	1NO+1NC	FM 18A2-M2	1NO+1NC	FM 18A4-M2	1NO+1NC
20	L	FM 2001-M2	1NO+2NC	FM 2002-M2	1NO+2NC	FM 20A2-M2	1NO+2NC	FM 20A4-M2	1NO+2NC
21	L	FM 2101-M2	3NC	FM 2102-M2	3NC	FM 21A2-M2	3NC	FM 21A4-M2	3NC
22	L	FM 2201-M2	2NO+1NC	FM 2202-M2	2NO+1NC	FM 22A2-M2	2NO+1NC	FM 22A4-M2	2NO+1NC
2	R	FM 201-M2	2x(1NO-1NC)	FM 202-M2	2x(1NO-1NC)	FM 2A2-M2	2x(1NO-1NC)	FM 2A4-M2	2x(1NO-1NC)
E1	E1	FM E101-M2	1NO-1NC	FM E102-M2	1NO-1NC	FM E1A2-M2	1NO-1NC	FM E1A4-M2	1NO-1NC
Max. speed		page 239 - type 4		page 239 - type 3		page 239 - type 3		page 239 - type 5	
Min. force		8 N (25 N ⊕)		6 N (25 N ⊕)		4.3 N (25 N ⊕)		4.3 N (25 N ⊕)	
Travel diagrams		page 240 - group 1		page 240 - group 2		page 240 - group 2		page 240 - group 1	

With stainless steel roller on request

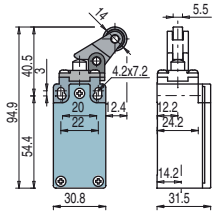

With external rubber gasket

With stainless steel roller on request

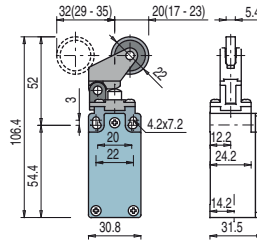
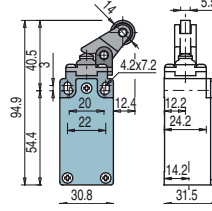

With external rubber gasket

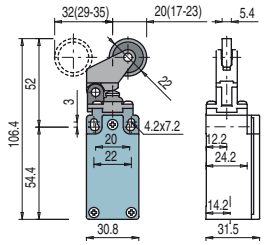

Contact blocks

5	R	FM 505-M2	1NO+1NC	FM 5A5-M2	1NO+1NC	FM 507-M2	1NO+1NC	FM 5A7-M2	1NO+1NC
6	L	FM 605-M2	1NO+1NC	FM 6A5-M2	1NO+1NC	FM 607-M2	1NO+1NC	FM 6A7-M2	1NO+1NC
7	LO	FM 705-M2	1NO+1NC	FM 7A5-M2	1NO+1NC	FM 707-M2	1NO+1NC	FM 7A7-M2	1NO+1NC
9	L	FM 905-M2	2NC	FM 9A5-M2	2NC	FM 907-M2	2NC	FM 9A7-M2	2NC
10	L	FM 1005-M2	2NO	FM 10A5-M2	2NO	FM 1007-M2	2NO	FM 10A7-M2	2NO
11	R	FM 1105-M2	2NC	FM 11A5-M2	2NC	FM 1107-M2	2NC	FM 11A7-M2	2NC
12	R	FM 1205-M2	2NO	FM 12A5-M2	2NO	FM 1207-M2	2NO	FM 12A7-M2	2NO
13	LV	FM 1305-M2	2NC	FM 13A5-M2	2NC	FM 1307-M2	2NC	FM 13A7-M2	2NC
14	LS	FM 1405-M2	2NC	FM 14A5-M2	2NC	FM 1407-M2	2NC	FM 14A7-M2	2NC
15	LS	FM 1505-M2	2NO	FM 15A5-M2	2NO	FM 1507-M2	2NO	FM 15A7-M2	2NO
18	LA	FM 1805-M2	1NO+1NC	FM 18A5-M2	1NO+1NC	FM 1807-M2	1NO+1NC	FM 18A7-M2	1NO+1NC
20	L	FM 2005-M2	1NO+2NC	FM 20A5-M2	1NO+2NC	FM 2007-M2	1NO+2NC	FM 20A7-M2	1NO+2NC
21	L	FM 2105-M2	3NC	FM 21A5-M2	3NC	FM 2107-M2	3NC	FM 21A7-M2	3NC
22	L	FM 2205-M2	2NO+1NC	FM 22A5-M2	2NO+1NC	FM 2207-M2	2NO+1NC	FM 22A7-M2	2NO+1NC
2	R	FM 205-M2	2x(1NO-1NC)	FM 2A5-M2	2x(1NO-1NC)	FM 207-M2	2x(1NO-1NC)	FM 2A7-M2	2x(1NO-1NC)
E1	E1	FM E105-M2	1NO-1NC	FM E1A5-M2	1NO-1NC	FM E107-M2	1NO-1NC	FM E1A7-M2	1NO-1NC
Max. speed		page 239 - type 3		page 239 - type 3		page 239 - type 3		page 239 - type 3	
Min. force		6 N (25 N ⊕)		4.3 N (25 N ⊕)		4 N (25 N ⊕)		3 N (25 N ⊕)	
Travel diagrams		page 240 - group 2		page 240 - group 2		page 240 - group 3		page 240 - group 3	

All measures in the drawings are in mm

Items with code on green background are stock items

Accessories See page 225